

# Crooked Two

2/5 Burrinjuck Lane, Dinner Plain, VIC. 3898



## FEATURES:

---



6 Occupancy



2 Bedroom



2 Bathroom



1 Car Parking



Dish Washer



Strict NO Party Policy



Strict NO Pets Accepted



Washing Machine

## ABOUT THIS PROPERTY

---

This 2 bedroom Chalet with views of the surrounding Park, offers open plan living including fully equipped kitchen with stone bench tops, European appliances, large dining table and living area to relax.

Retreat to the bright and spacious master bedroom with King Bed, built in robes and well appointed ensuite.

This is a self contained property & is not serviced during your stay. Crooked 2 is NOT pet friendly.

## KITCHEN & COOKING FACILITIES

---

Modern fully equipped kitchen and a dining area for 6 people

## BEDROOMS & BEDDING CONFIGURATION

---

Bedroom 1 (2nd floor): 1 x King Bed

Bedroom 2 (ground floor) 2 x Bunk

## BATHROOMS

---

Bathroom 1: this is the ensuite to bedroom 1 and has a walk-in shower, vanity and toilet

Bathroom 2: Shower over bath, vanity and toilet

## HEATING & COOLING FACILITIES

---

Gas fire place Electric panel heating throughout.

## LAUNDRY DETAILS

---

The apartment contains a washing machine and dryer

## ENTERTAINMENT FACILITIES

---

flat screen TV, Stereo and DVD player

## PARKING

---

There is one parking space at this property

## PETS

---

This property is not pet friendly

# Crooked Two

2/5 Burrinjuck Lane, Dinner Plain, VIC. 3898

## Crooked 2

2/5 Burrinjuck Lane, Dinner plain

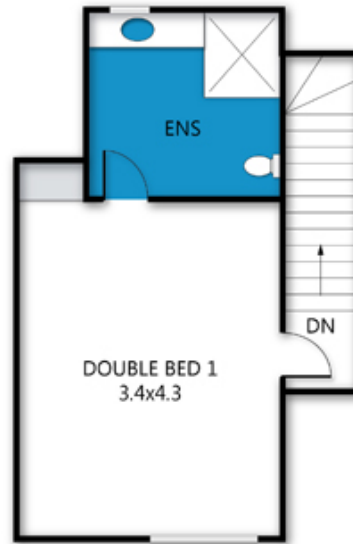

SECOND FLOOR

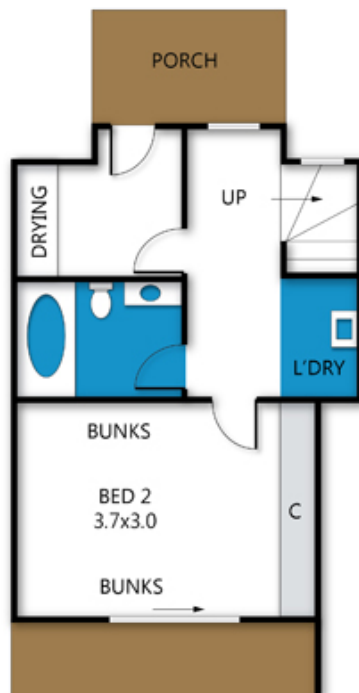

GROUND FLOOR

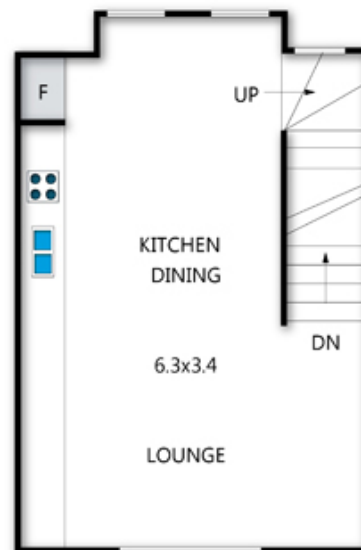

FIRST FLOOR

archistyle

Whilst every attempt has been made to ensure the accuracy of this floorplan, measurements of doors, windows, rooms and any other items are approximate only. The producer or the agent cannot be held responsible for any errors, omissions or misstatements. This plan is for illustrative purposes only and should be used as such.

# Crooked Two

2/5 Burrinjuck Lane, Dinner Plain, VIC. 3898

